

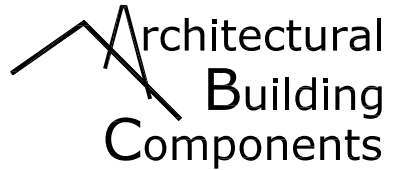

CONTINUOUS CLIP
 2-PIECE
 4EA #14 X 1" HWH SDS
 (2 PER SIDE)



11625 N. HOUSTON ROSSLYN RD. (281) 931-3986
 HOUSTON, TX. 77086 (800) 423-1105
 www.archmetalroof.com FAX: (281) 931-3989

PANEL:		DATE:	03/03/09
	238T STANDING SEAM PANEL	DET. #	238T-1
DETAIL:	FLOATING EAVE-OVER PURLINS		

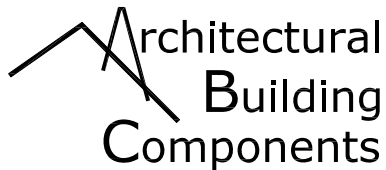
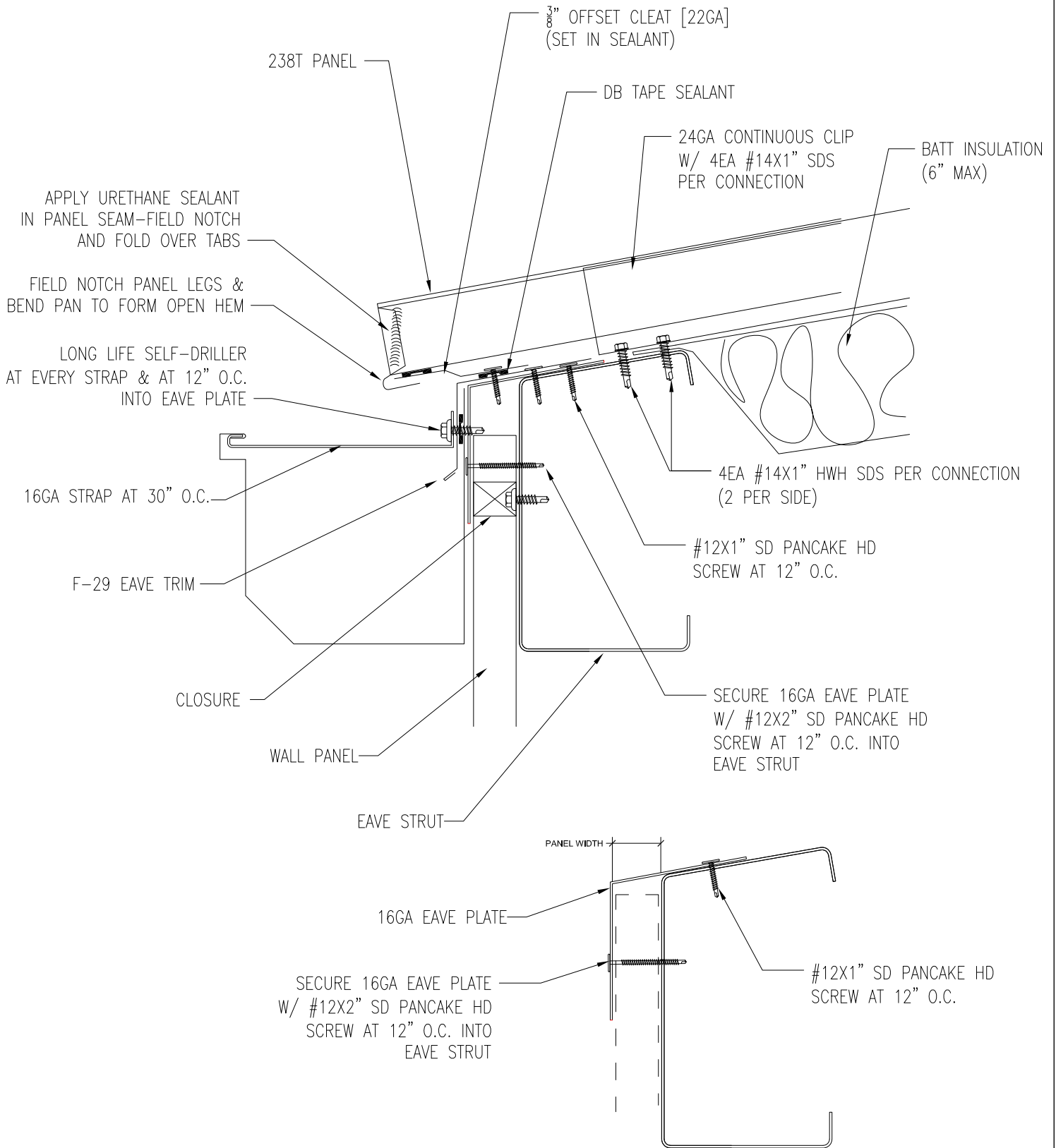

11625 N. HOUSTON ROSSLYN RD.
HOUSTON, TX. 77086
www.archmetalroof.com

(281) 931-3986
(800) 423-1105
FAX: (281) 931-3989

PANEL:

238T STANDING SEAM PANEL

DETAIL:

FLOATING EAVE-OVER PURLINS

DATE:

03/03/09

DET. #

238T-V1

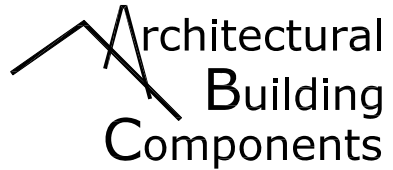
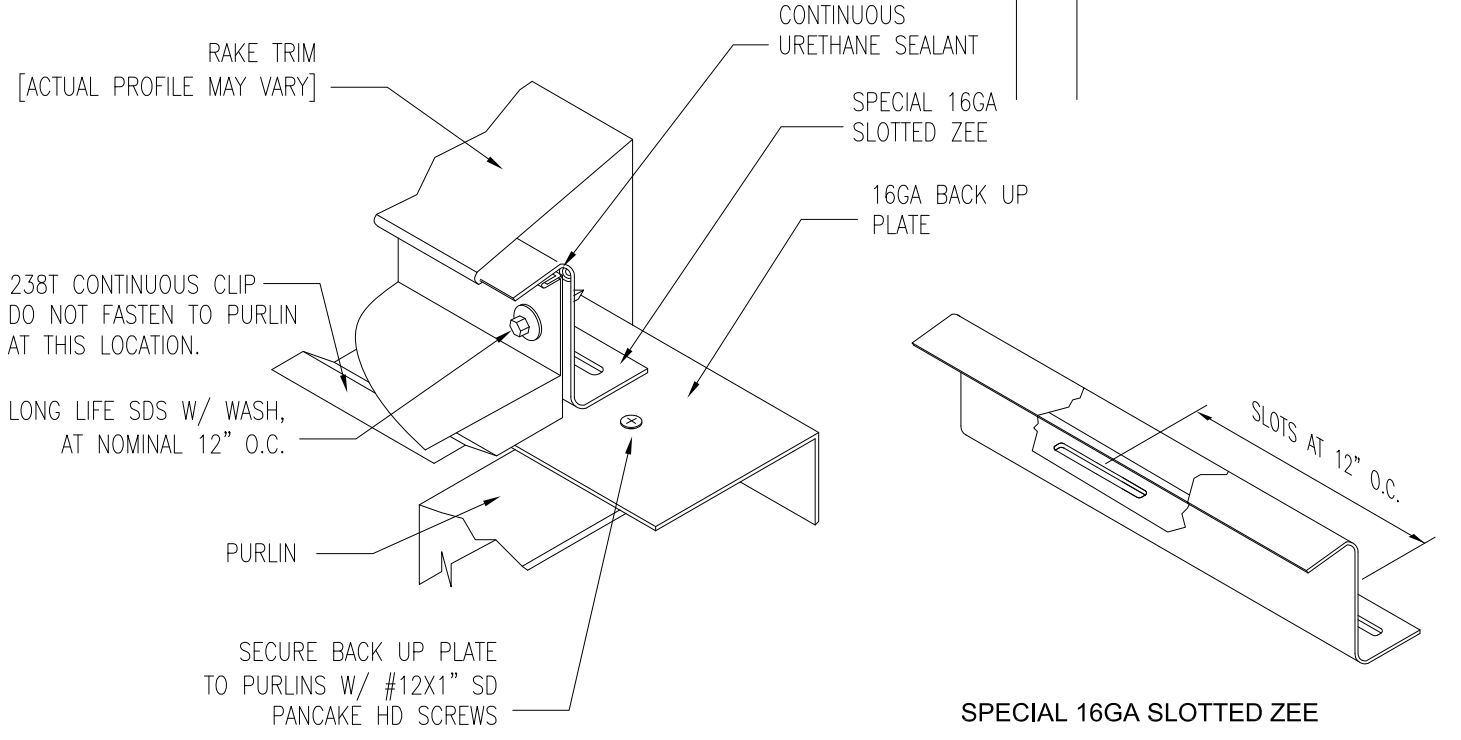
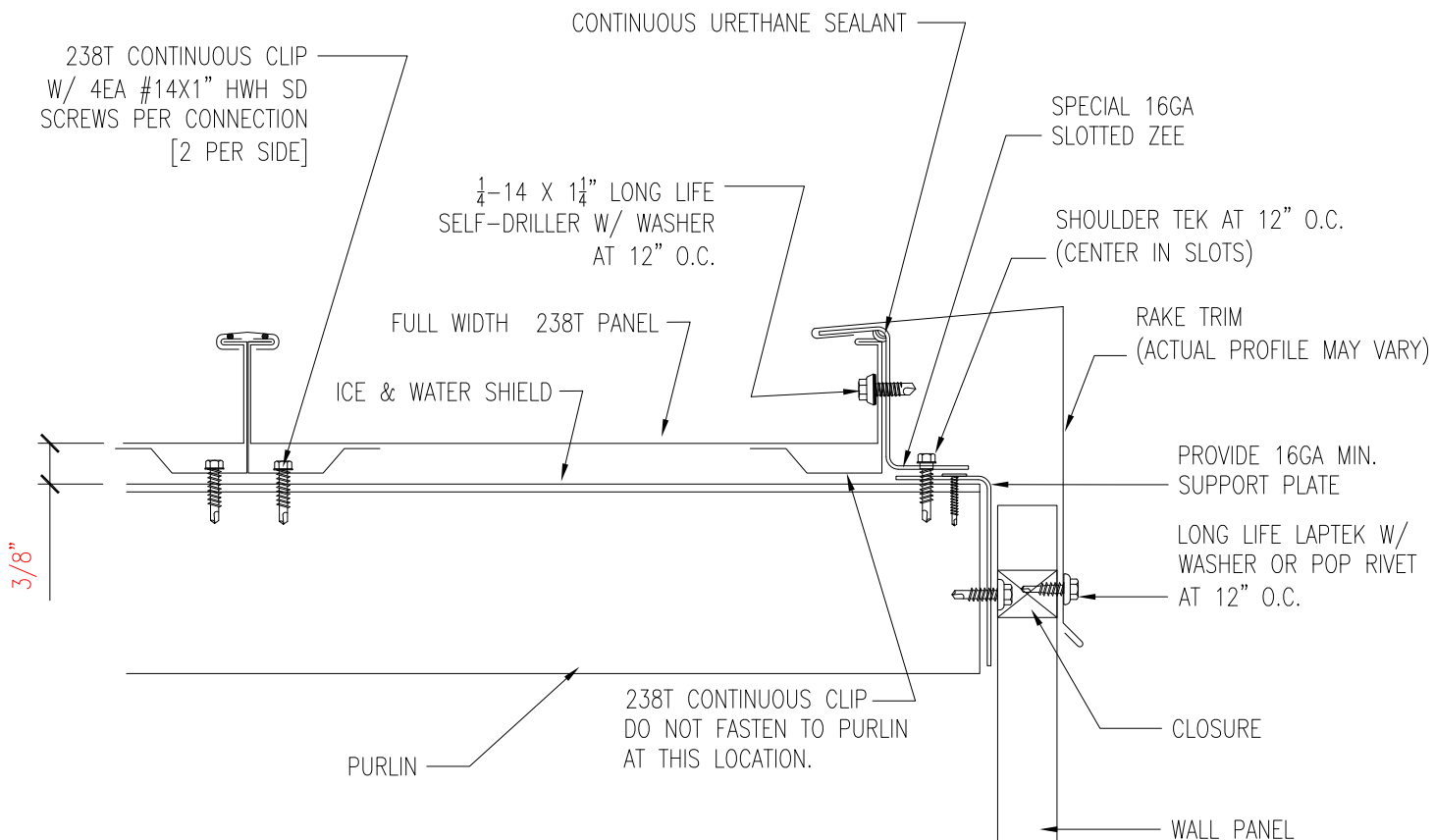

11625 N. HOUSTON ROSSLYN RD. (281) 931-3986
HOUSTON, TX. 77086 (800) 423-1105
www.archmetalroof.com FAX: (281) 931-3989

PANEL:		DATE:	03/16/09
	238T STANDING SEAM PANEL	DET. #	238T-3
DETAIL:	FLOATING RAKE-OVER PURLINS		

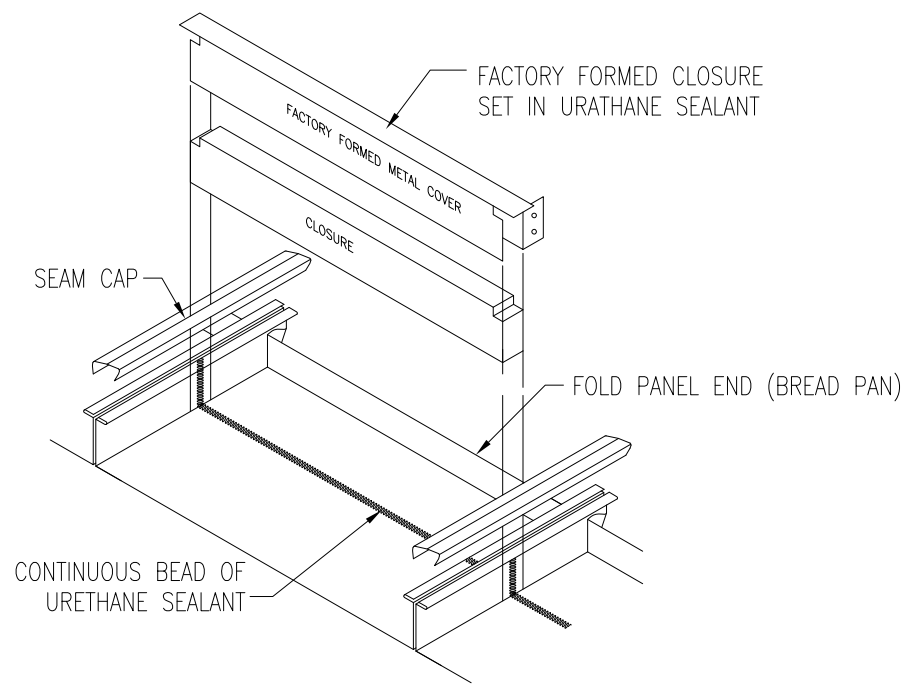
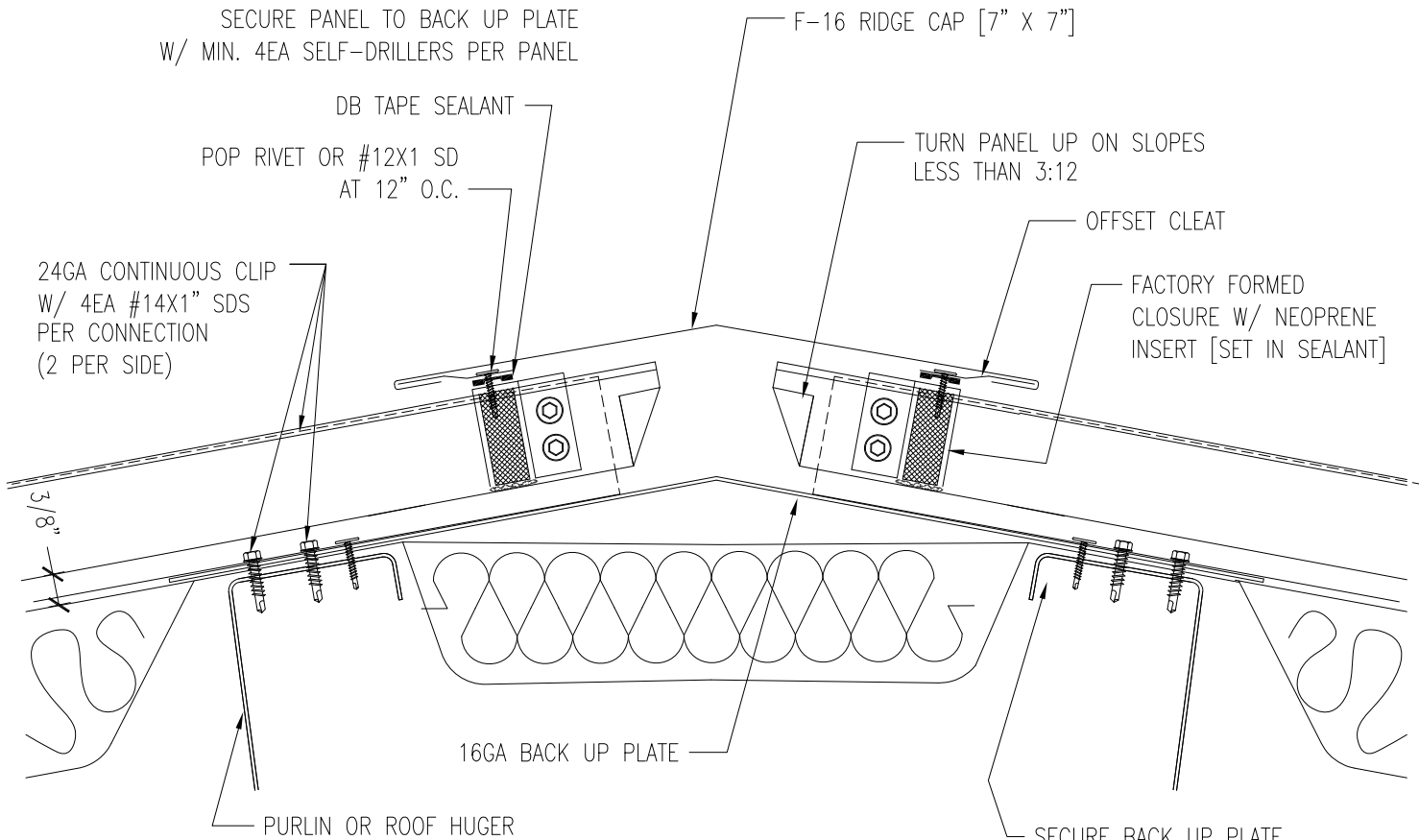

TURN PANEL UP ON SLOPES LESS THAN 3:12

OFFSET CLEAT

FACTORY FORMED CLOSURE W/ NEOPRENE INSERT [SET IN SEALANT]

SECURE BACK UP PLATE TO PURLINS W/ #12X1" SD PANCAKE HD SCREWS AT 12" O.C.

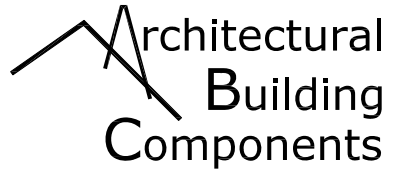

11625 N. HOUSTON ROSSLYN RD.
HOUSTON, TX. 77086
www.archmetalroof.com

(281) 931-3986
(800) 423-1105
FAX: (281) 931-3989

PANEL: 

238T STANDING SEAM PANEL

DETAIL: 

FIXED RIDGE OVER PURLINS

DATE:
03/24/09

DET. #

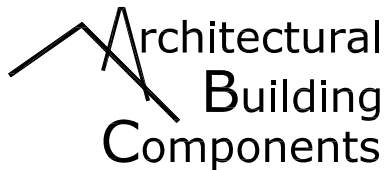
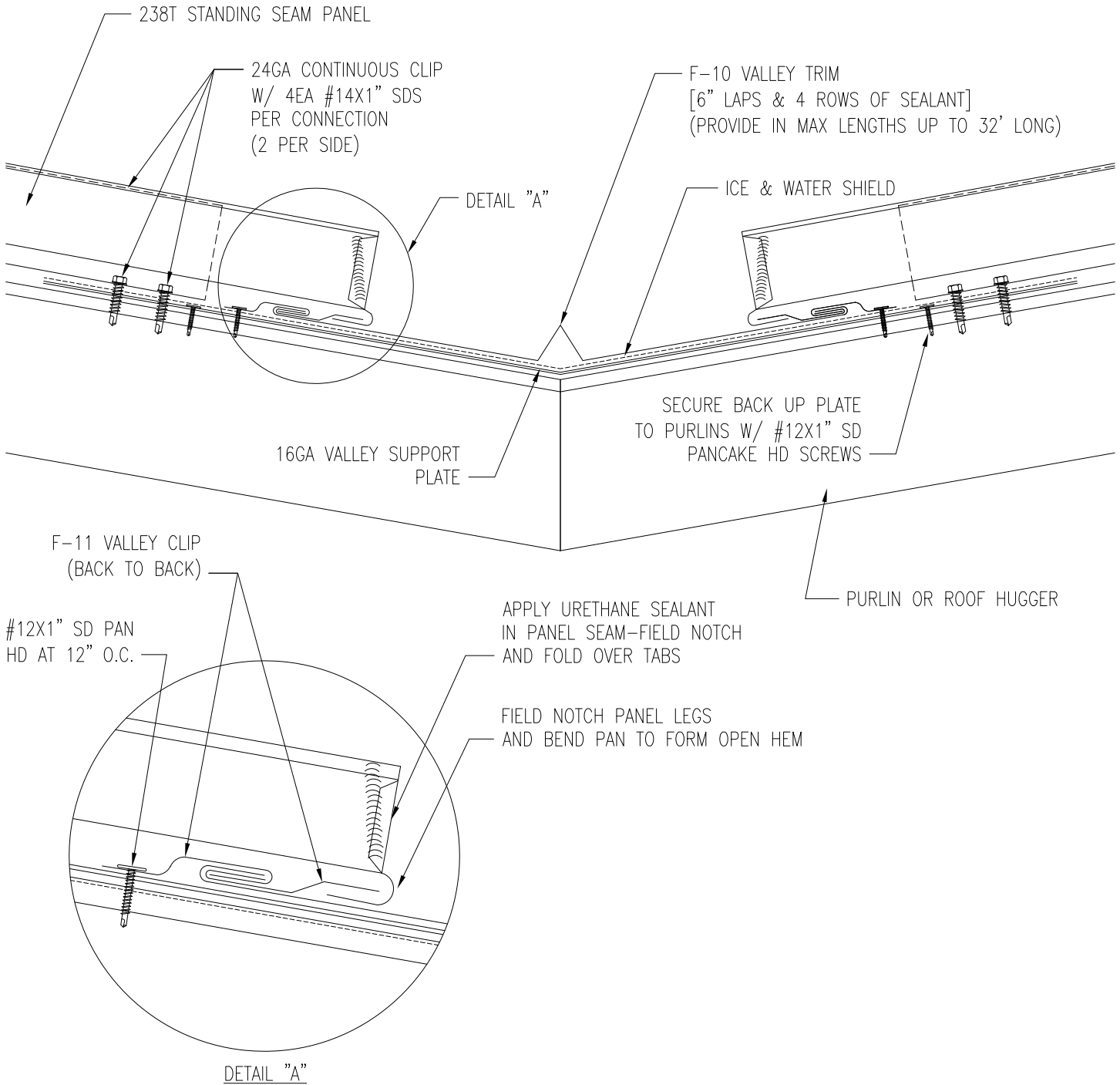

11625 N. HOUSTON ROSSLYN RD.
HOUSTON, TX. 77086
www.archmetalroof.com

(281) 931-3986
(800) 423-1105
FAX: (281) 931-3989

PANEL:

238T STANDING SEAM PANEL

DETAIL:

STANDARD VALLEY OVER PURLINS

DATE:

03/03/09

DET. #

238T-4