

NOTE:
CUT ZEE CLOSURE TO SLOPE ANGLE, NOTCH TO FIT
BETWEEN SEAMS AND CAULK AT BOTH ENDS.

- ① JSM 300
- ② HIP/RIDGE TRIM
- ③ ZEE CLOSURE
- ④ TAPE SEAL
- ⑤ BACKER PLATE

ISOMETRIC AT HIP

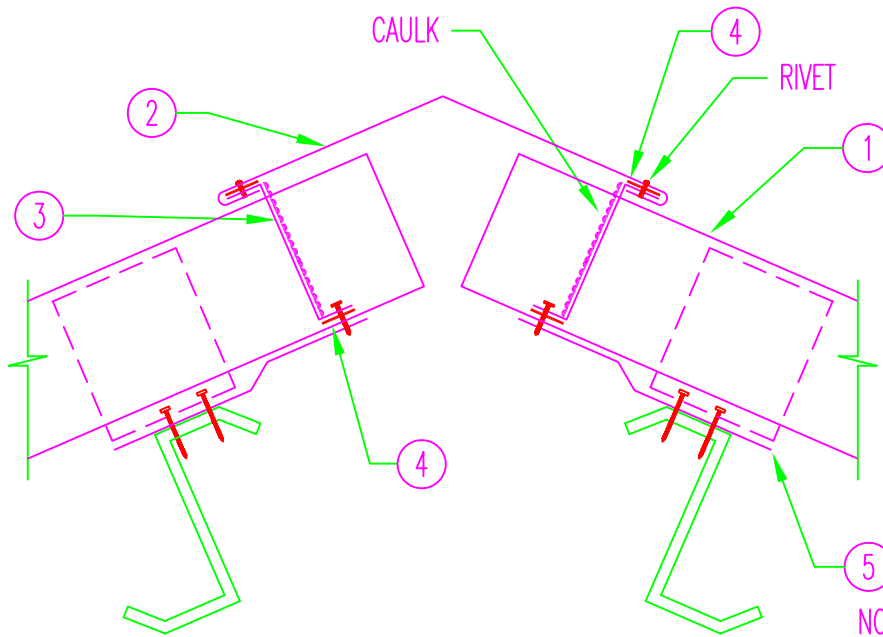

SECTION HIP/RIDGE

NOTE:
USE A PERFORATED ZEE
CLOSURE TO ACHIEVE A
VENTED RIDGE CONDITION.

ARCHITECTURAL BUILDING COMPONENTS
11625 N. HOUSTON ROSSLYN RD.
HOUSTON, TX. 77086
(281) 931-3986 OR (800) 423-1105
FAX: (281) 931-3989
www.archmetalroof.com

DETAIL:

HIP/RIDGE DETAIL

PANEL TYPE:

JSM ROOF SYSTEM

DATE:

10-10-02

DETAIL #:

J3-8